

FUNCTION DESCRIPTION

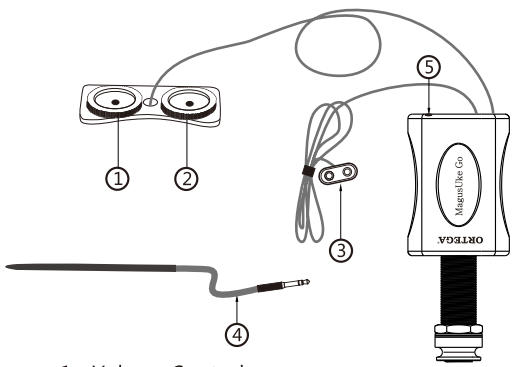

- 1、Volume Control
- 2、Tone Control
- 3、Connect Of Battery
- 4、Pickup
- 5、2.5mm input of pickup

- *Convenient Output Jack Style Pickup (easy to install, no need to cut the hole in the side of guitar)*
- *Flexible pickup*
- *Setup with volume and tone control*
- *Base output: high-end output with 6.5mm high impedance*
- *Power supply:9V*

ORTEGA®

MagusUke Go

Output Jack Pickup Style Manual

INSTALLATION

Step 1: Make a hole at the tail of the guitar with 12mm drill, then fit the output jack in.

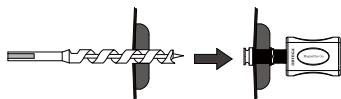

Step 2: Pickup installation

- * Make clean and flat for bottom of bridge cavity.
- * cut at 45° in the end of the bridge cavity with 3.2mm hole, install the pickup according to pic ②.

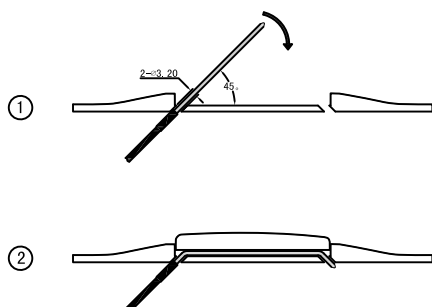

Step 3: Place the battery bag with 9V battery in, tie up the spare cable then stick at the back inside of the guitar

